

PLANTA BAIXA PAGINAÇÃO  
Esc: 1/100

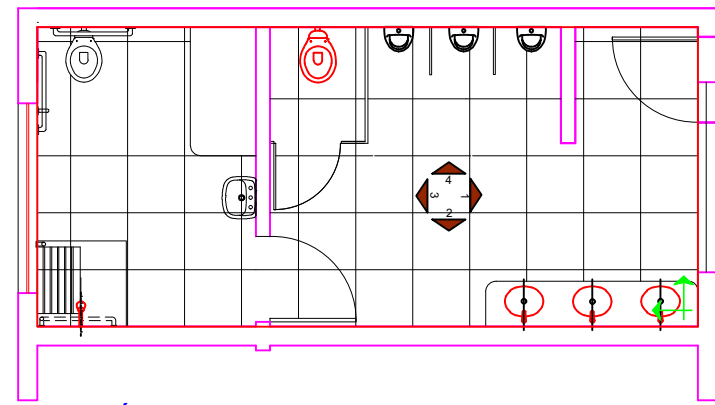

SANITÁRIO MAS 1

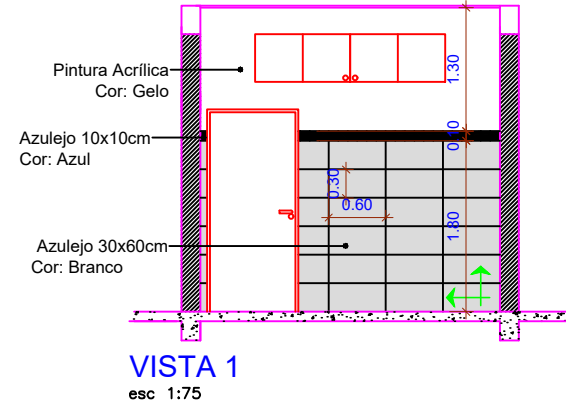

VISTA 1  
esc: 1:75

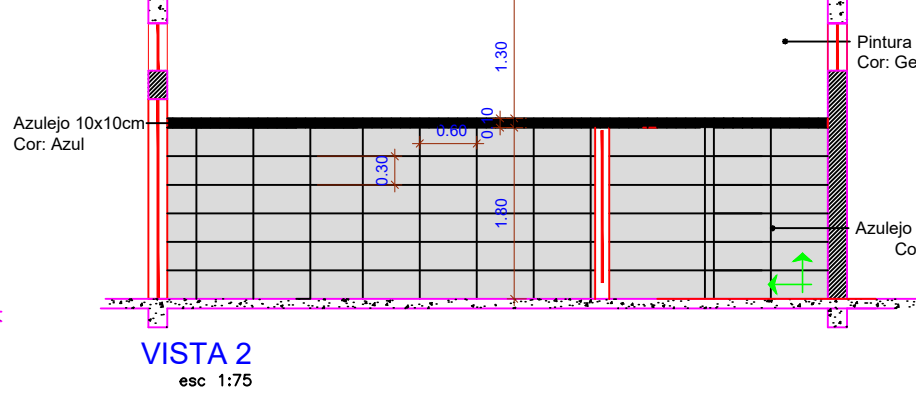

VISTA 2  
esc: 1:75

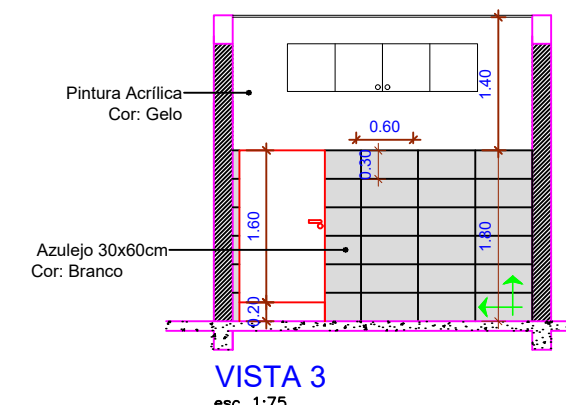

VISTA 3  
esc: 1:75

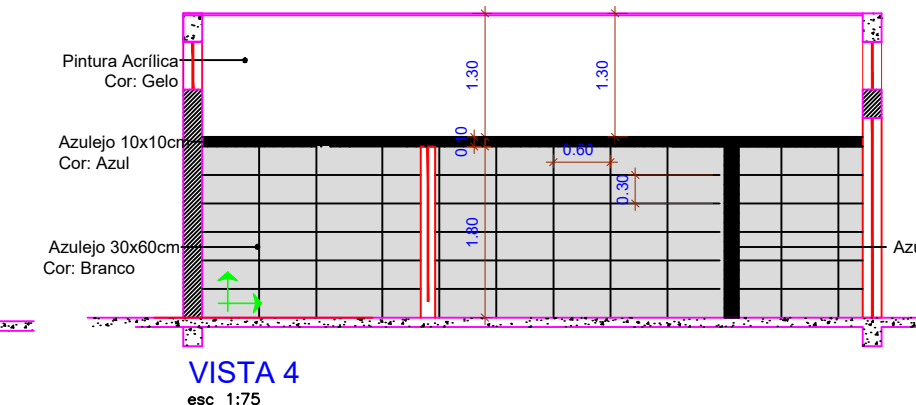

VISTA 4  
esc: 1:75

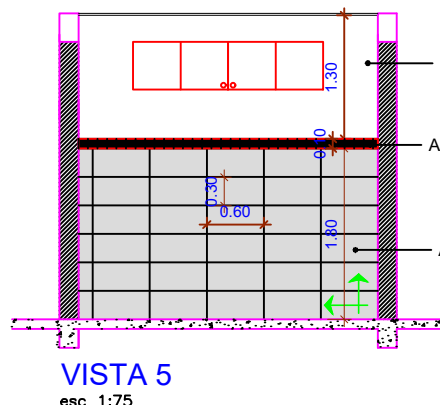

VISTA 5  
esc: 1:75

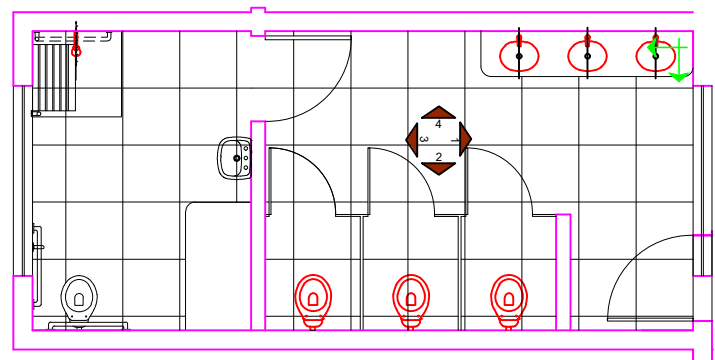

SANITÁRIO FEM 1

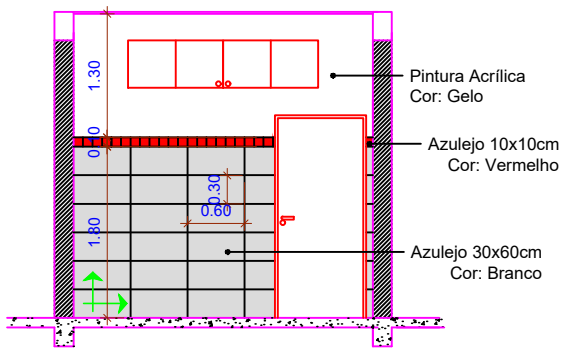

VISTA 1  
esc: 1:75

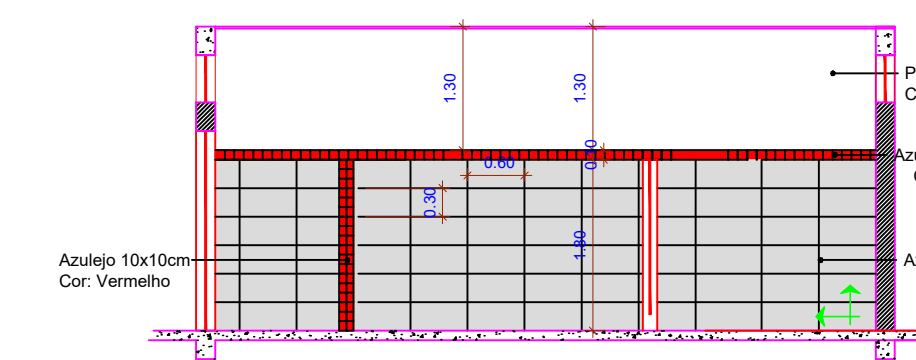

VISTA 2  
esc: 1:75

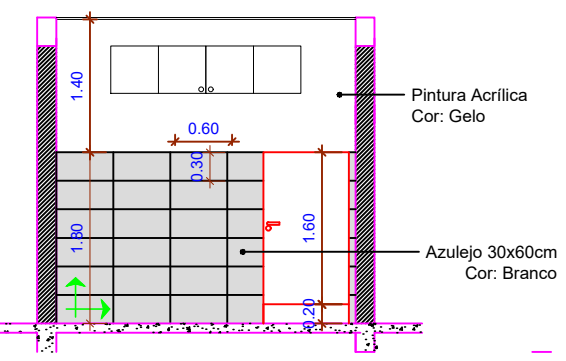

VISTA 3  
esc: 1:75

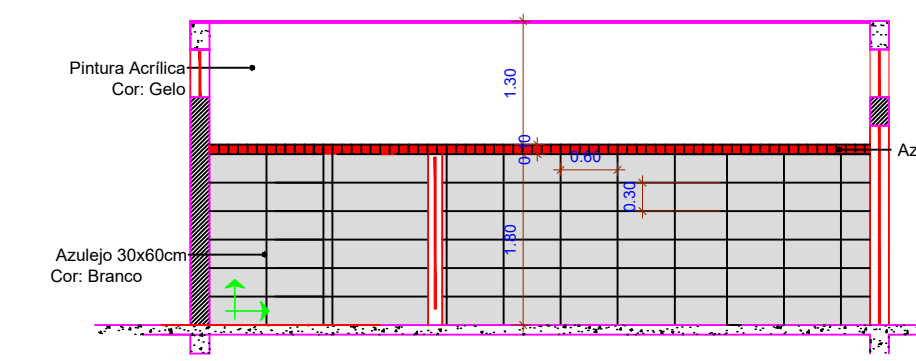

VISTA 4  
esc: 1:75

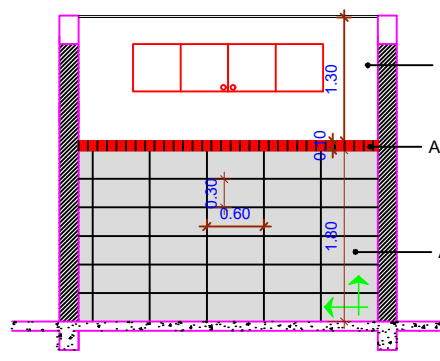

VISTA 5  
esc: 1:75

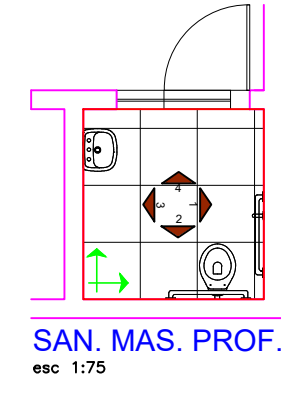

SAN. MAS. PROF.  
esc: 1:75

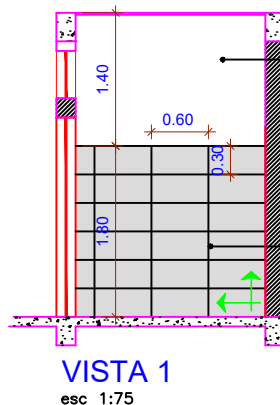

VISTA 1  
esc: 1:75

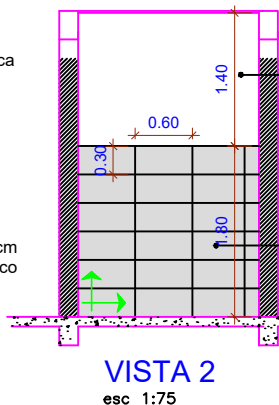

VISTA 2  
esc: 1:75

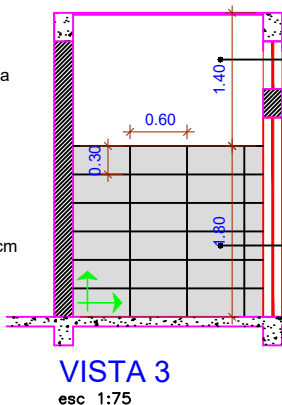

VISTA 3  
esc: 1:75

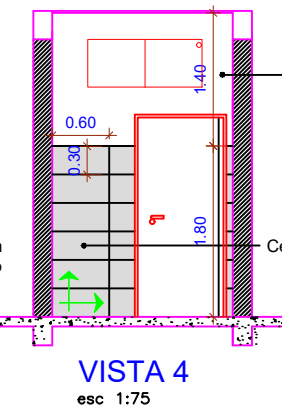

VISTA 4  
esc: 1:75

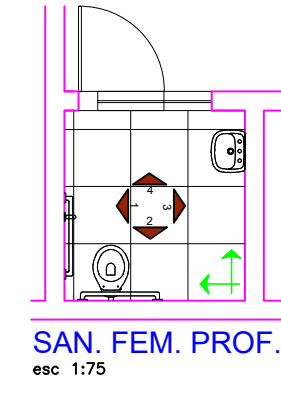

SAN. FEM. PROF.  
esc: 1:75

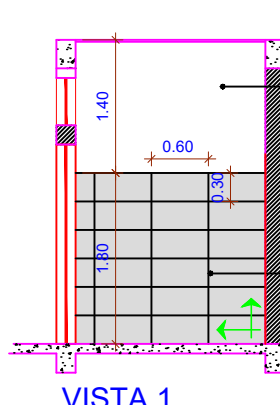

VISTA 1  
esc: 1:75

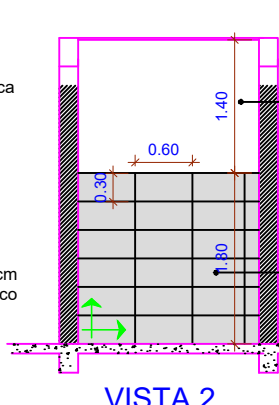

VISTA 2  
esc: 1:75

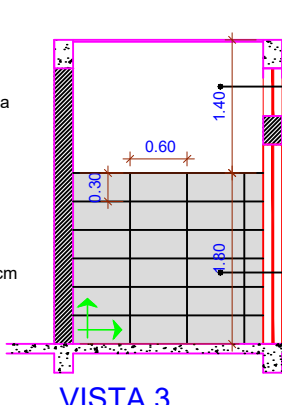

VISTA 3  
esc: 1:75

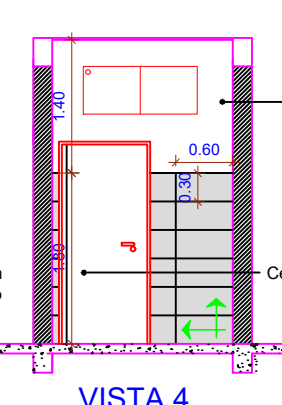

VISTA 4  
esc: 1:75

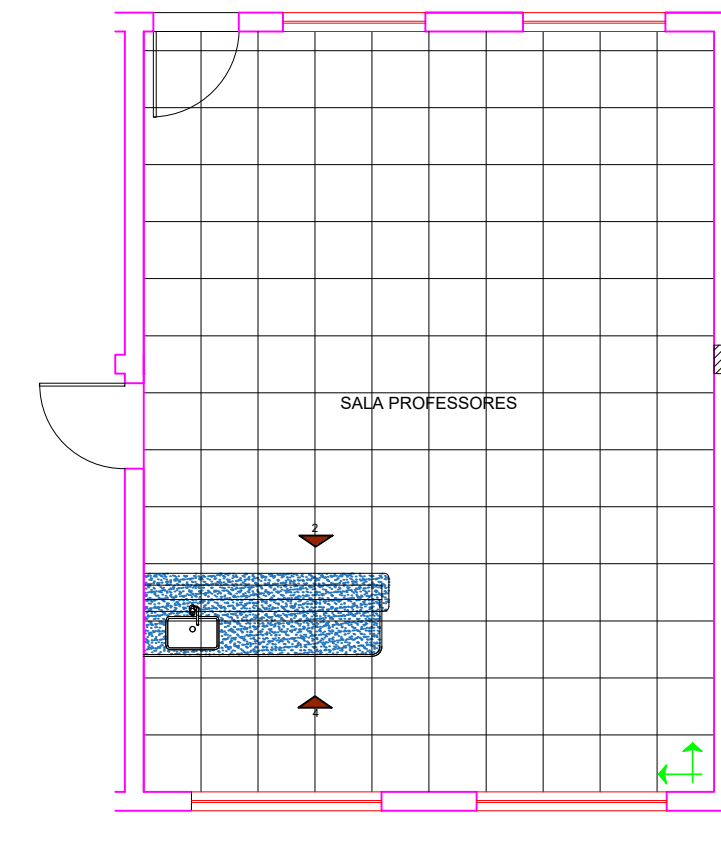

SALAS DE PROFESSORES  
esc: 1:75

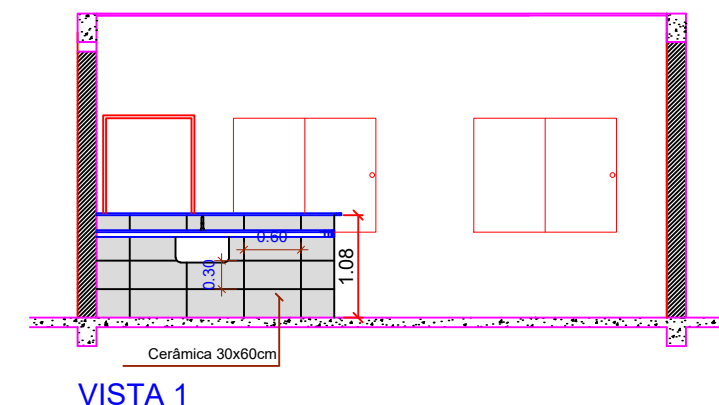

VISTA 1  
esc: 1:75

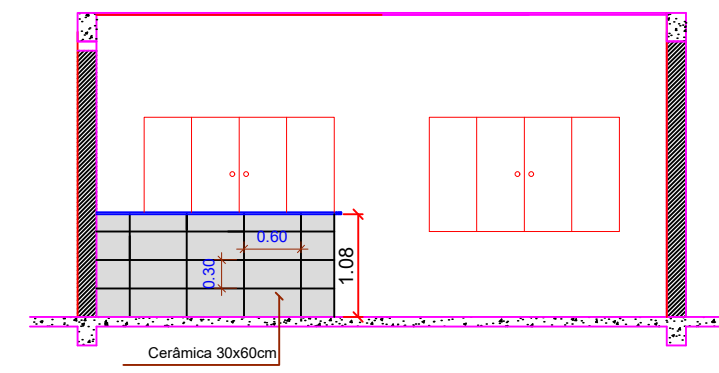

VISTA 2  
esc: 1:75

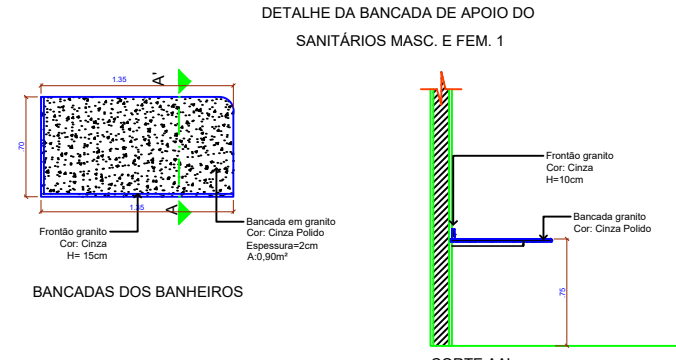

BANCADAS DOS BANHEIROS

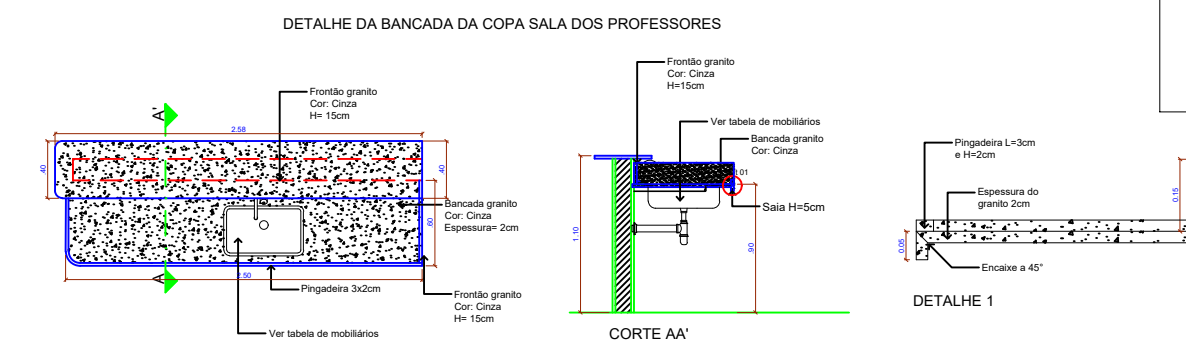

BANCADA DA COPA SALA DOS PROFESSORES

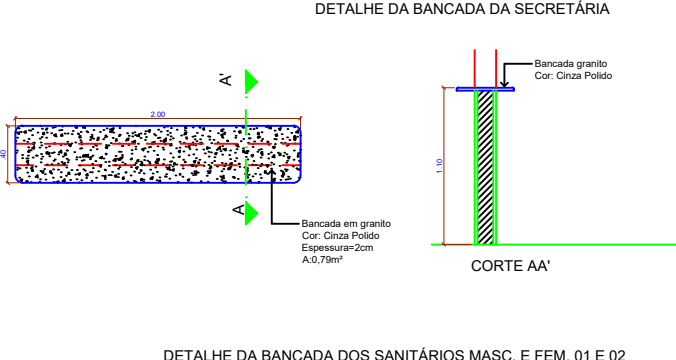

BANCADA DA SECRETARIA

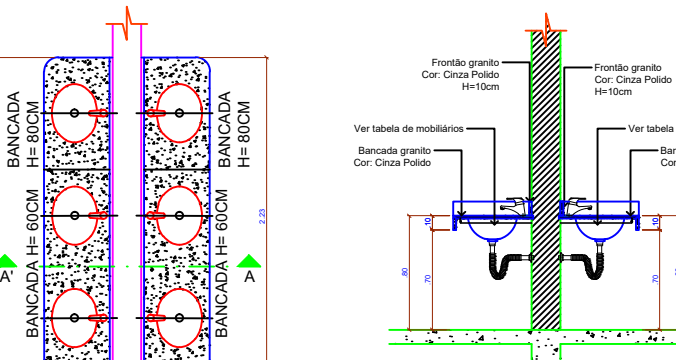

BANCADA DOS SANITÁRIOS MASC. E FEM. 01 E 02

| TABELA DE PAGINAÇÃO |  |                  |
|---------------------|--|------------------|
| GRÁFICO             | DESCRIÇÃO  | QUANTIDADE       |
| 1                   | CERÂMICO RETIFICADO ACETINADO 60x60cm CINZA OU SIMILAR |                  |
| 2                   | SOLEIRA GRANITO CINZA ANDORINHA                        | 37,45 m          |
| 3                   | PINGADEIRA CINZA ANDORINHA                             | 28,00 m          |
| 4                   | BANCADA EM GRANITO CINZA ANDORINHA                     | Ver Detalhamento |
| 5                   | CALÇADA DE ENTORNO PISO DE CONCRETO 6CM                |                  |



Departamento de Engenharia

Avenida Valdir Mazutti, nº 1999, Bom Jardim - Campos de Júlio  
Fone: 0xx65-3387-2800

|        |  |
|--------|--|
| Obras: | CONSTRUÇÃO DE CENTRO DE EDUCAÇÃO INFANTIL COM 14 SALAS DE AULA Localizado na Av. Gov. Júlio Campos Quadra 01 |
| Área:  | Área a Construir 1.967,40 m²   |

|   |   |
|---|---|
| Prefeitura Municipal de Campos de Júlio | Responsável Técnico Cíntya Vieira Souto CAU: A 160810-0 |
|---|---|

|           |                          |  |
|-----------|--------------------------|--|
| Conteúdo: | ARQUITETÔNICO -Paginação | DECLARO QUE A APROVAÇÃO DO PROJETO NÃO IMPLICA NO RECONHECIMENTO POR PARTE DA PREFEITURA DO DIREITO DE PROPRIEDADE DO TERRENO. |
|-----------|--------------------------|--|

|       |           |         |           |          |                     |        |  |
|-------|-----------|---------|-----------|----------|---------------------|--------|--|
| Data: | MAIO/2022 | Escala: | INDICADAS | Desenho: | CINTYA VIEIRA SOUTO | Folha: |  |
|-------|-----------|---------|-----------|----------|---------------------|--------|--|