

PLANTA BAIXA PAGINAÇÃO  
Esc: 1/100

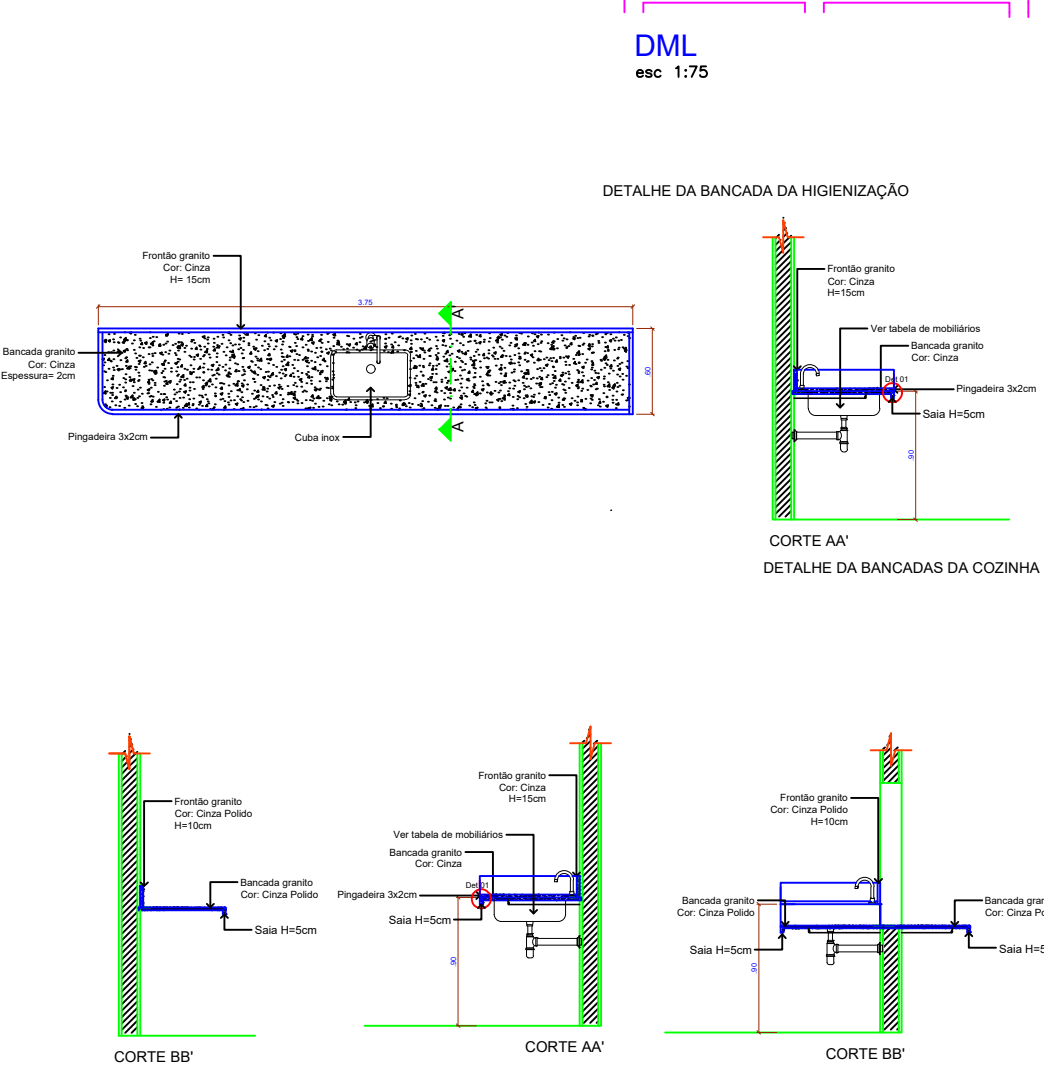

DETALHE DA BANCADA DA HIGIENIZAÇÃO

DETALHE DA BANCADA DA COZINHA

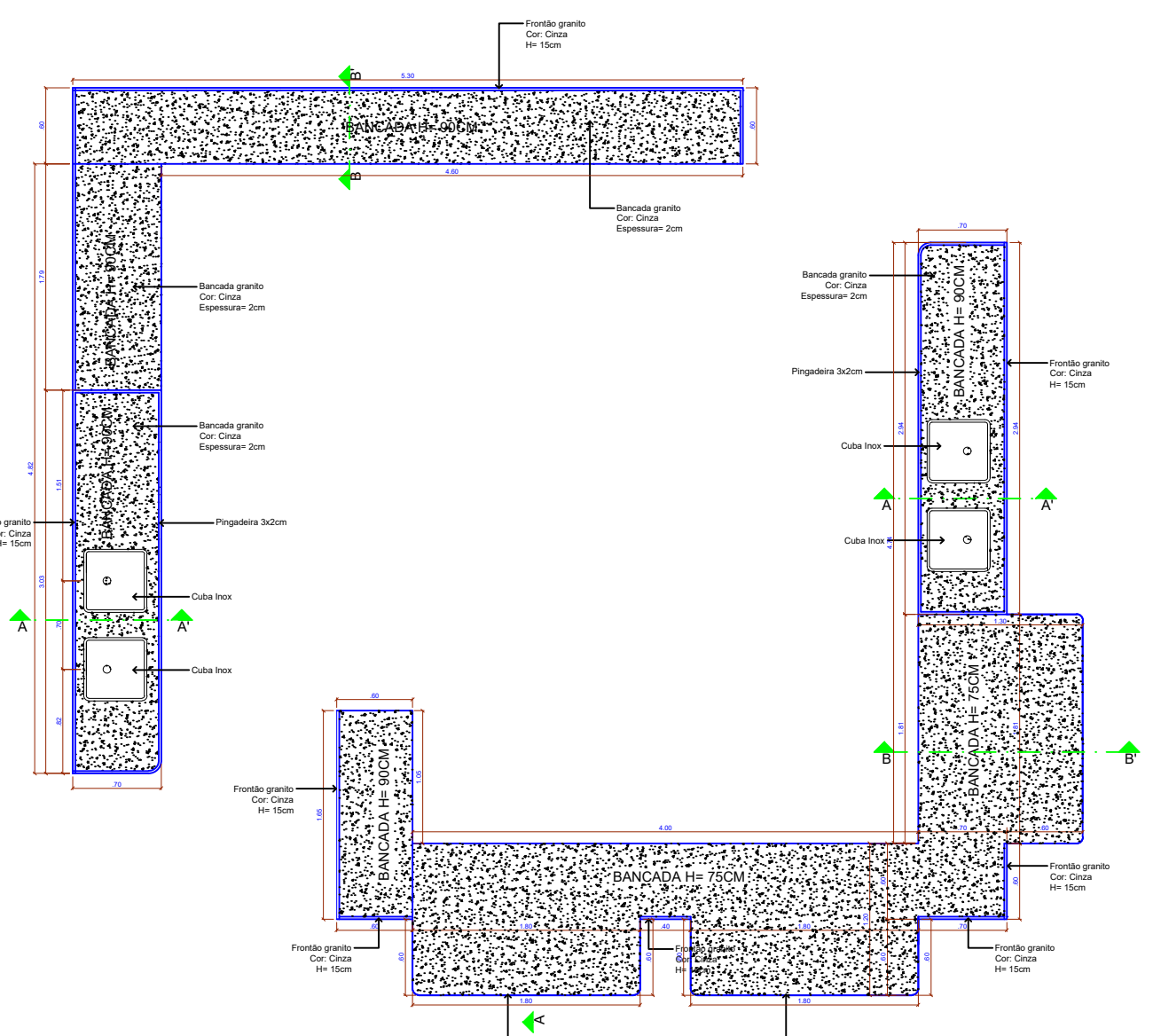
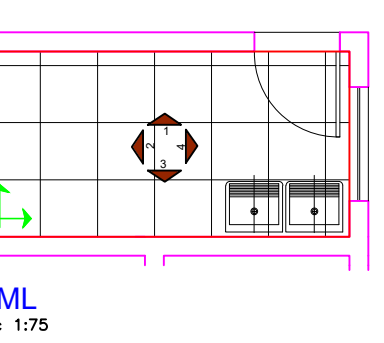

D.M.L.  
esc: 1/75

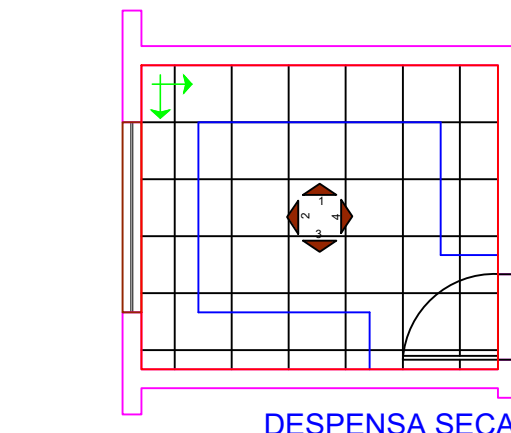

DESPENSA SECA  
esc: 1/75

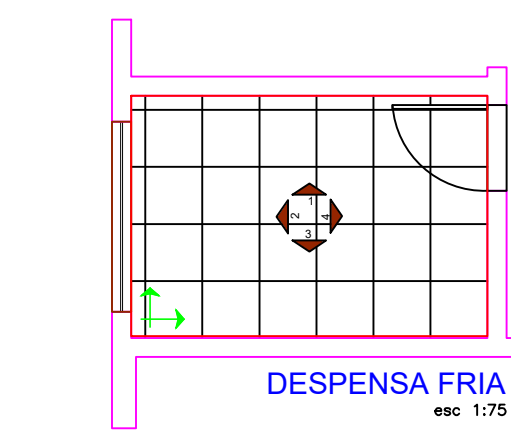

DESPENSA FRIA  
esc: 1/75

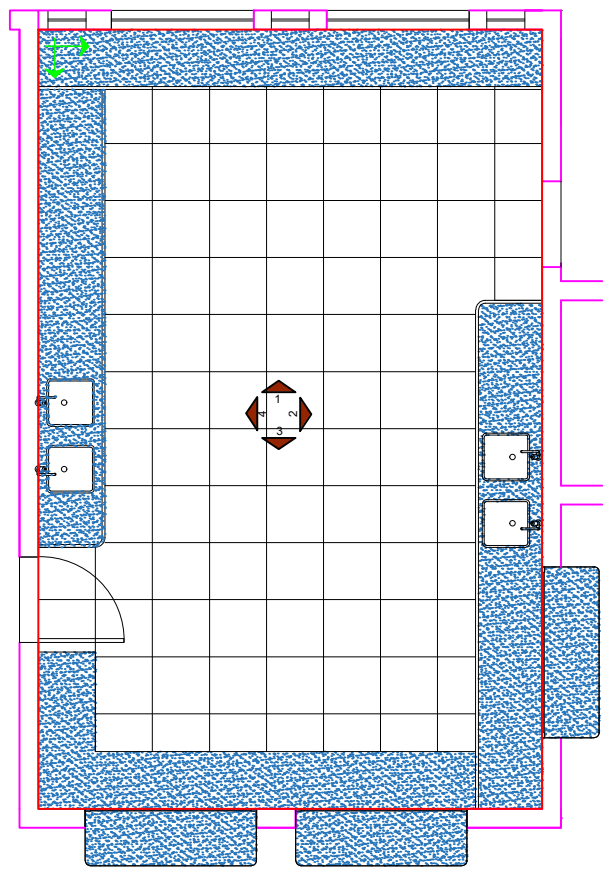

COZINHA  
esc: 1/75

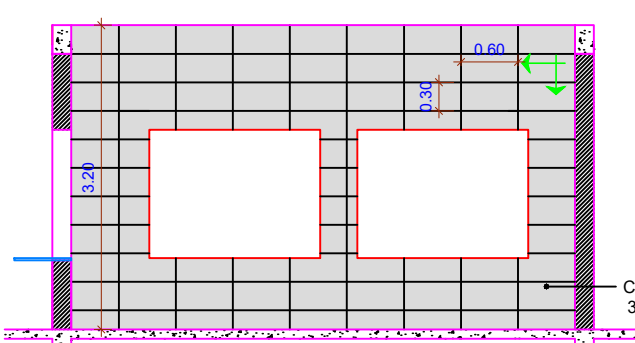

VISTA 1  
esc: 1/75

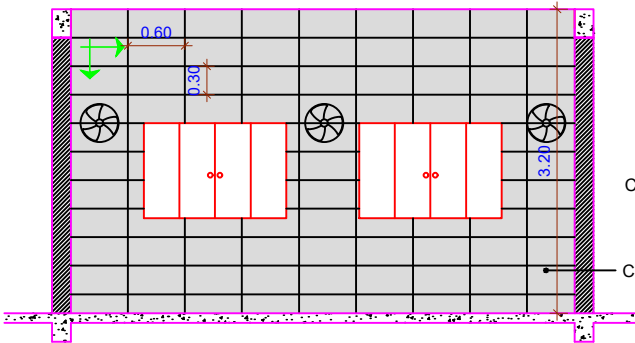

VISTA 2  
esc: 1/75

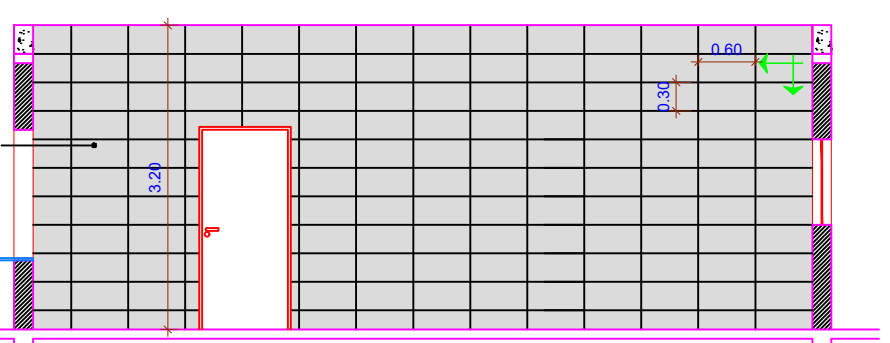

VISTA 3  
esc: 1/75

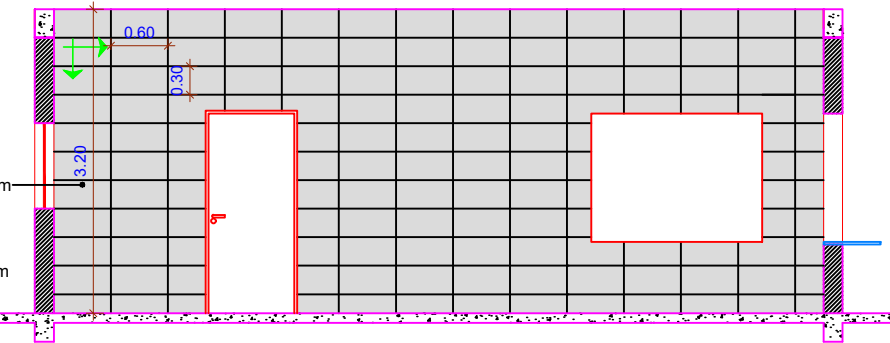

VISTA 4  
esc: 1/75

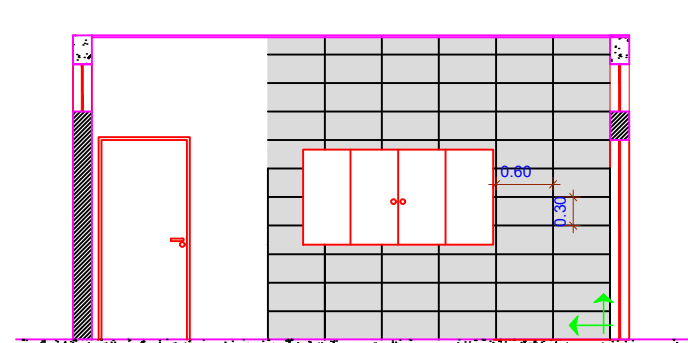

VISTA 1  
esc: 1/75

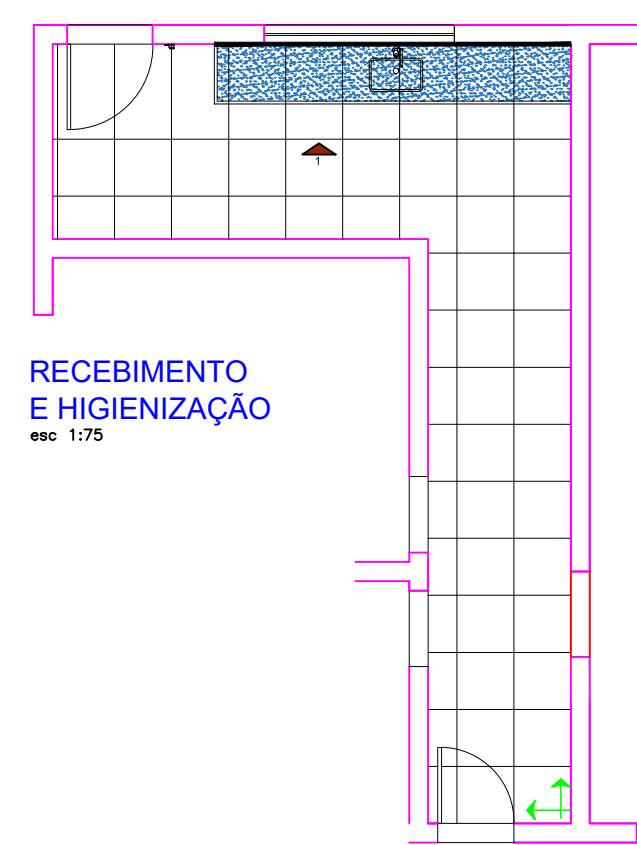

RECEBIMENTO E HIGIENIZAÇÃO  
esc: 1/75

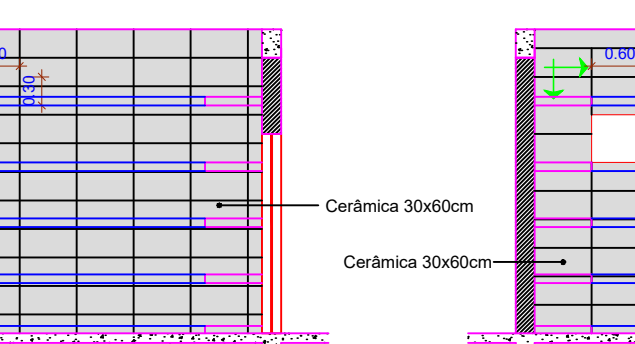

VISTA 1  
esc: 1/75

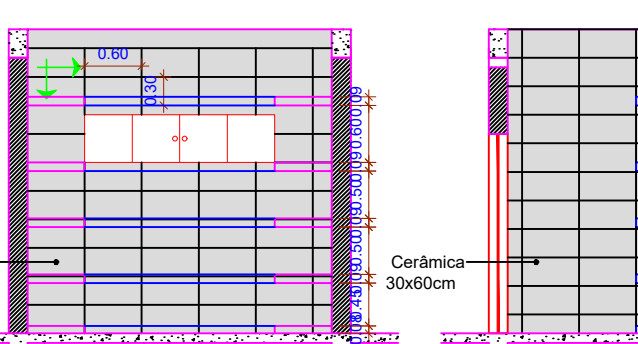

VISTA 2  
esc: 1/75

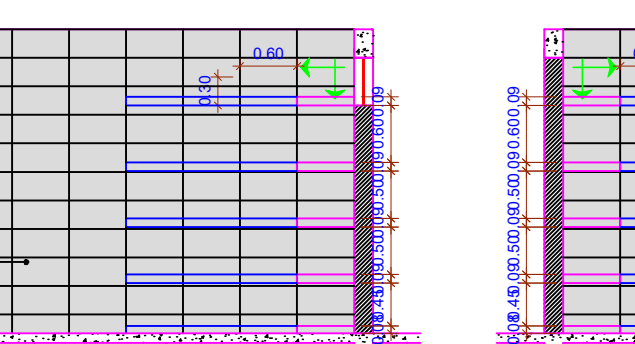

VISTA 3  
esc: 1/75

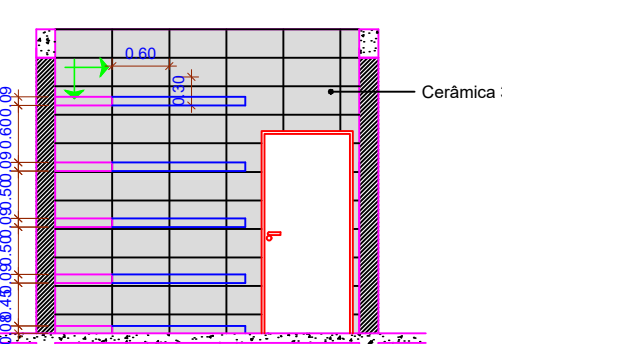

VISTA 4  
esc: 1/75

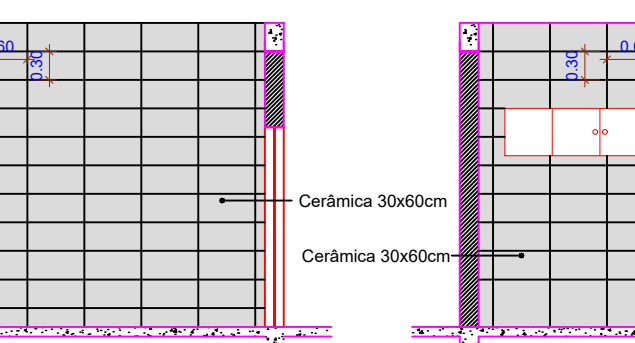

VISTA 1  
esc: 1/75

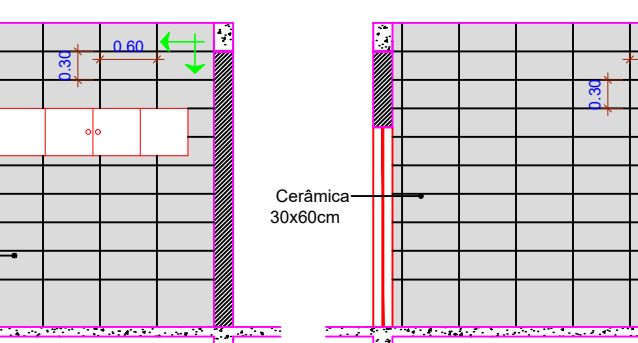

VISTA 2  
esc: 1/75

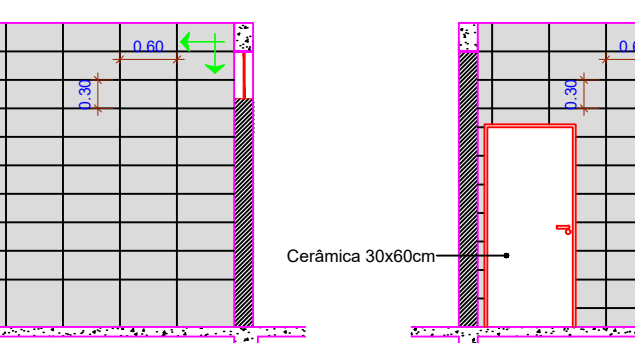

VISTA 3  
esc: 1/75

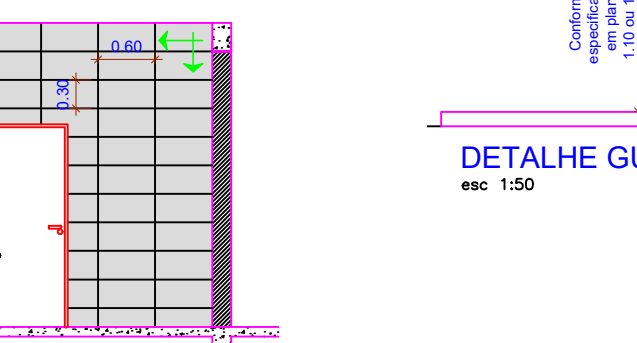

VISTA 4  
esc: 1/75

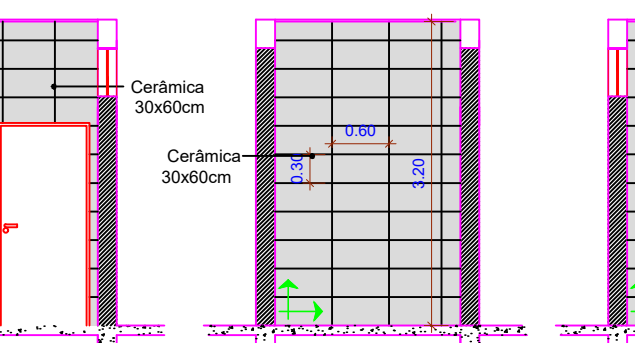

VISTA 2  
esc: 1/75

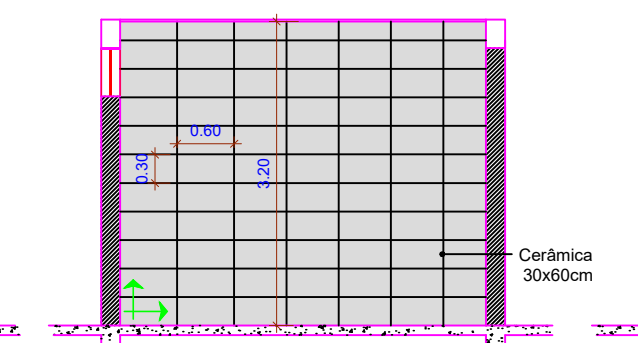

VISTA 2  
esc: 1/75

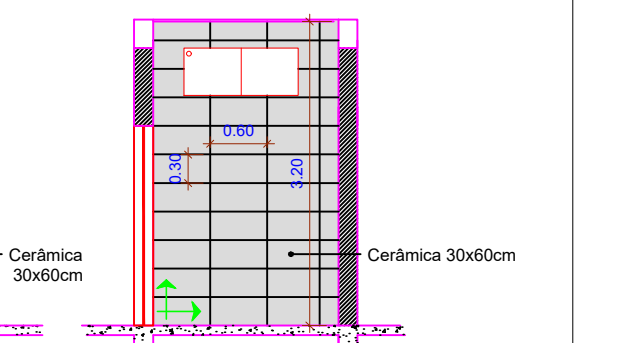

VISTA 3  
esc: 1/75



VISTA 4  
esc: 1/75

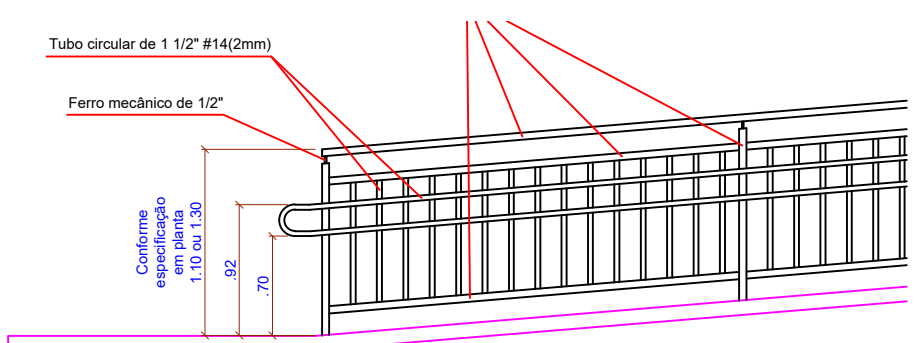

DETALHE GUARDA-CORPO E CORRIMÃO  
esc: 1/50

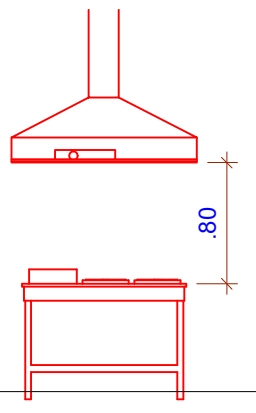

DETALHE COIFA  
esc: 1/50

GRÁFICO	DESCRIÇÃO	QUANTIDADE
	1 - CERÂMICO RETIFICADO ACETINADO 60x60cm CINZA OU SIMILAR	21,30 m
	2 - SOLEIRA GRANITO CINZA ANDORINHA	15,60 m
	3 - PINGADEIRA CINZA ANDORINHA	Ver Detalhamento
	4 - BANCADA EM GRANITO CINZA ANDORINHA	Ver Detalhamento
	5 - CALÇADA DE ENTORNO PISO DE CONCRETO 6CM	55,52 m²
	6 - PISO DE CONCRETO 6CM	6,54 m²



Departamento de Engenharia

Avenida Valdir Mazutti, nº 1999, Bom Jardim - Campos de Júlio  
Fone: 0xx65-3387-2800

Obras: CONSTRUÇÃO DE CENTRO DE EDUCAÇÃO INFANTIL COM 14 SALAS DE AULA Localizado na Av. Gov. Júlio Campos Quadra 01

Área: Área a Construir 1.967,40 m²

Prefeitura Municipal de Campos de Júlio

Responsável Técnico CINTYA VIEIRA SOUTO CAU: A 160810-0

Conteúdo: ARQUITETÔNICO -Paginação

DECLARO QUE A APROVAÇÃO DO PROJETO NÃO IMPLICA NO RECONHECIMENTO POR PARTE DA PREFEITURA DO DIREITO DE PROPRIEDADE DO TERRENO.

Data: MAIO/2022

Escala: INDICADAS

Desenho: CINTYA VIEIRA SOUTO

Folha: